

**DETAILING OF HANDRAIL AT ON HORIZONTAL MEMBERS**

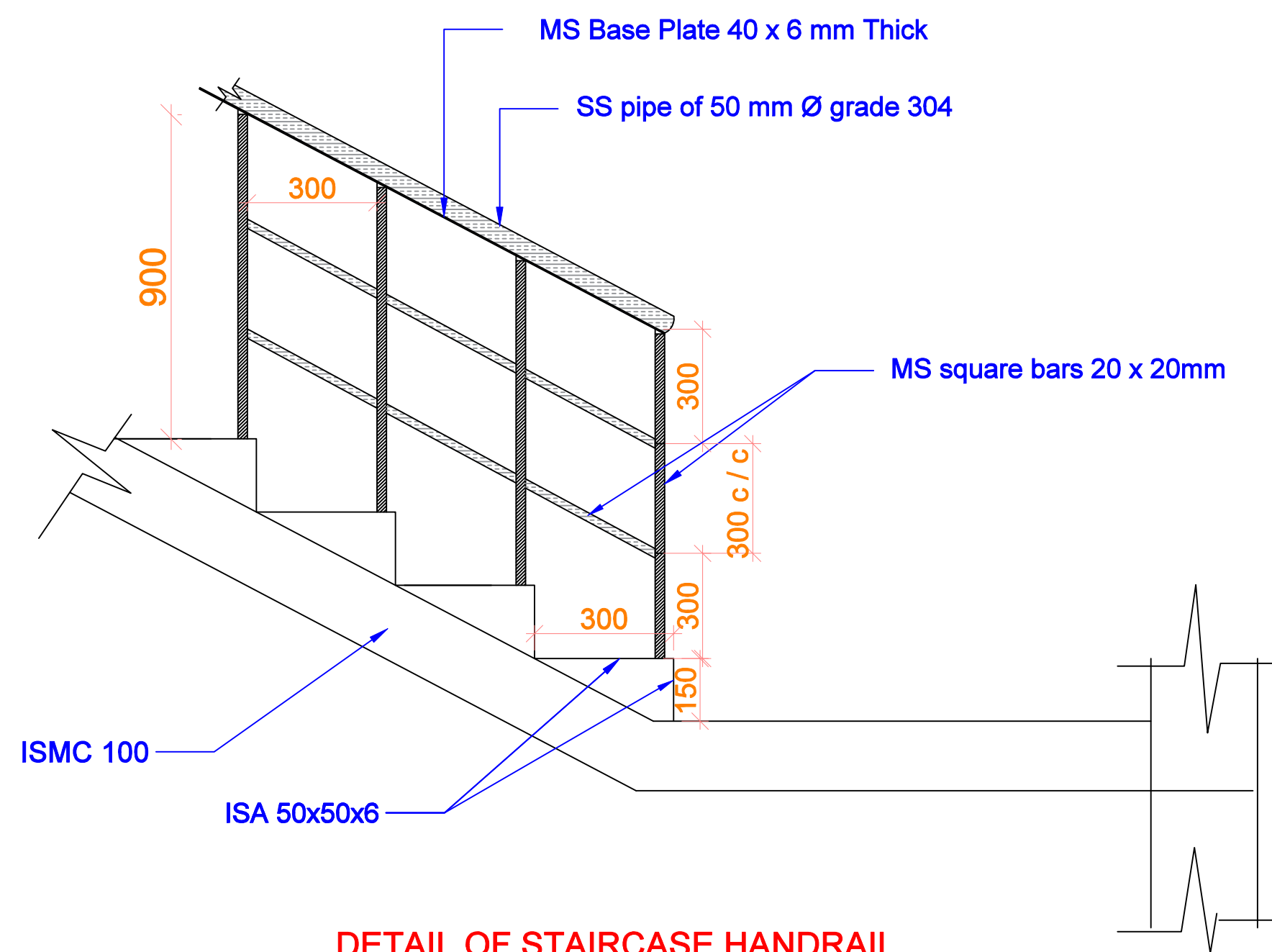

**DETAIL OF STAIRCASE HANDRAIL**

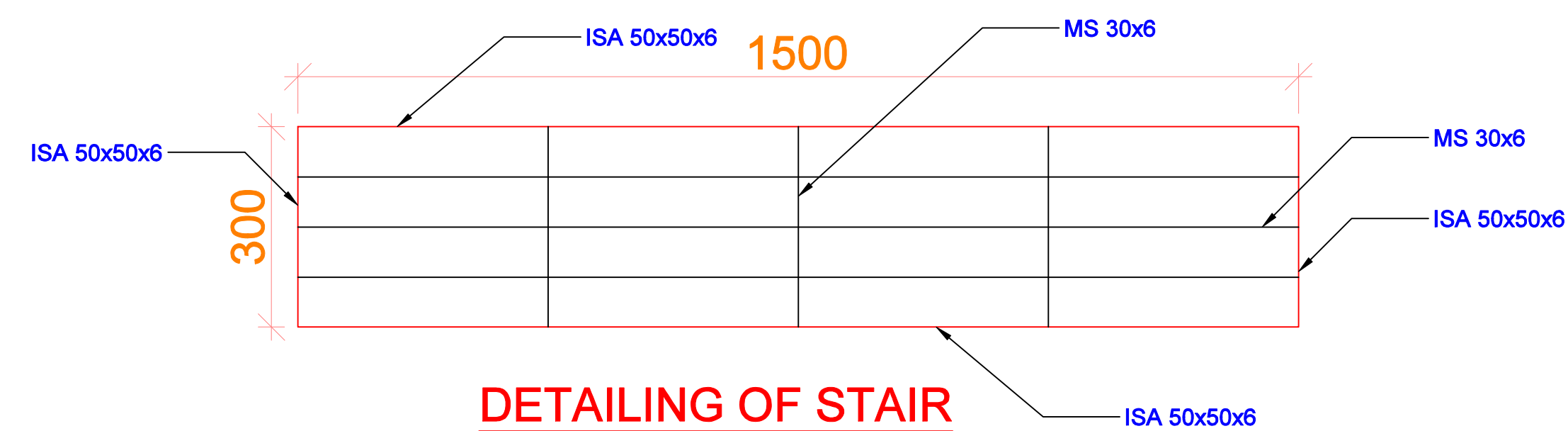

**DETAILING OF STAIR**

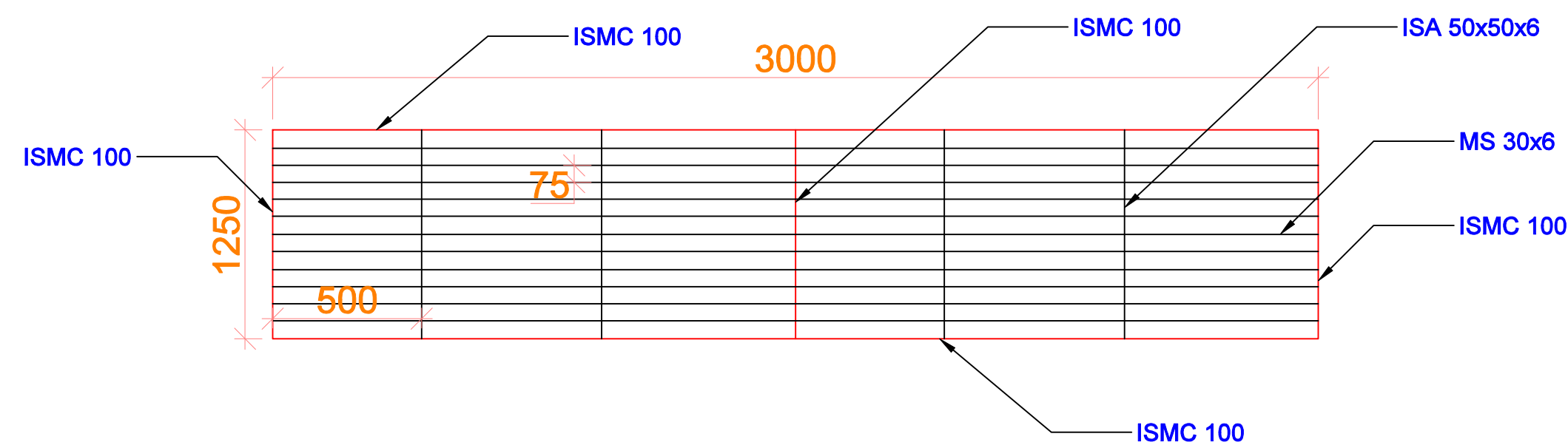

**DETAILING OF STAIRCASE LANDING**

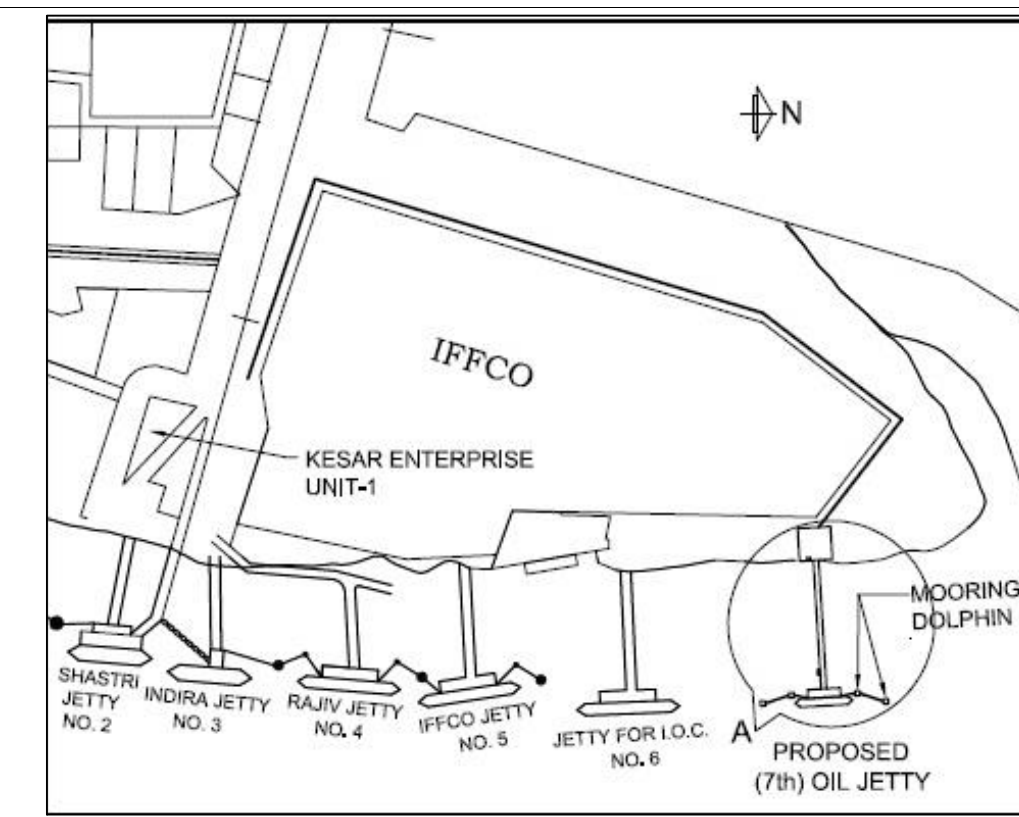

**KEY PLAN  
(NOT SCALE)**

**NOTES:-**

1. ALL LEVELS ARE IN METER & ALL DIMENSIONS ARE IN MILLIMETER UNLESS OTHERWISE SPECIFIED.
2. ALL STRUCTURAL STEEL WORK SHALL BE MILD STEEL AND AS PER IS:2062.
3. ALL STRUCTURAL STEEL IS DESIGNED AS PER IS:800:2007.
4. ALL WELDING SHALL BE DONE AS PER IS:816 (LATEST) FOR FULL CONTACT LENGTH.
5. ALL FILLET WELDS ARE 8mm, UNLESS OTHERWISE SPECIFIED.
6. ENGINEER IN CHARGE SHOULD ENSURE THAT FILLET/BUTT WELD ARE KEPT INTACT.
7. ALL GUSSET PLATES ARE 10mm THICK, UNLESS OTHERWISE SPECIFIED.
8. ALL BUTT WELDS SHALL BE FULL PENETRATION WELD.
9. WELD STRENGTH ARE 189 N/MM FOR SHOP WELDING AND 157 N/MM FOR FIELD WELD.
10. ALL WELDS WILL BE IN FULL LENGTH AROUND EACH MEMBER AT EACH JOINT.
11. ALL MEMBERS MEETING AT A JOINT ARE FILLET WELDED UNLESS OTHERWISE NOTED.
12. EXACT SIZE OF GUSSET PLATE TO BE DETERMINED IN TEMPLATE SHOP.
13. DO NOT SCALE THE DRAWING, WRITTEN DIMENSION SHALL ONLY BE FOLLOWED.
13. DISCREPANCY IF ANY, SHOULD BE BROUGHT TO THE NOTICE OF THE APPROVING AUTHORITY.

**GOOD FOR CONSTRUCTION**

REVISION	REV.NO	DATE	REVISED BY	DESCRIPTION
----------	--------	------	------------	-------------

CLIENT :	<b>M/s DEENDAYAL PORT AUTHORITY</b>
JOB :	<b>PROPOSED OIL JETTY NO.7 AT KANDLA PORT</b>
TITLE :	<b>DETAILS OF CONTROL ROOM AT PUMP HOUSE</b>

CONSULTANT :	 aarvee associates architects engineers & consultants pvt.ltd. Ravula Residency, Srinagar Colony Main Rd., Hyderabad-82, India Tel: +91-40-23737633; Fax: +91-40-23736277 e-mail: Ports@aarvee.net; web: www.aarvee.net
--------------	---