

PROGRAMME MANAGER

**PROJECT**

**Development of Smart Industrial Port City (SIPC) Location 1 & 2 at Kandla - Gandhidham - Adipur Complex**

TITLE

COORDINATES OF PLOT AREA  
FOR LOCATION - 2  
AT KANDLA

Drawn: K. Kant		Checked: V. Anand	
Designed: R. Sajith		Approved: H. Kumar	

Drawing No:	REV.
-----	R0

DPT, Gandhidham	DATE
-----------------	------





G.P.S. COORDINATES LIST		
PT. NO.	POINT COORDINATES NORTHING - (N)	POINT COORDINATES EASTING - (E)
A	23° 04' 54.60"	70° 09' 22.17"
B	23° 04' 49.18"	70° 09' 34.32"
C	23° 04' 42.79"	70° 09' 51.67"
D	23° 04' 41.20"	70° 09' 55.90"
E	23° 04' 34.58"	70° 09' 54.95"
F	23° 04' 34.02"	70° 09' 59.81"
G	23° 04' 05.20"	70° 09' 58.69"
H	23° 04' 04.08"	70° 09' 57.13"
I	23° 04' 14.24"	70° 09' 49.72"
J	23° 04' 17.63"	70° 09' 46.74"
K	23° 04' 27.98"	70° 09' 34.96"
L	23° 04' 38.55"	70° 09' 23.40"
M	23° 04' 40.12"	70° 09' 22.57"
N	23° 04' 42.83"	70° 09' 22.45"
O	23° 04' 47.52"	70° 09' 22.14"
P	23° 04' 47.53"	70° 09' 21.97"

PART - 2		
COLOR LEGEND :-		
1) FULL RED LINE SHOWN EXISTING PLOT BOUNDARY LINE	---	
2) BLACK ROUND SHOWN CORNER POINT	●	
3) FULL RED LINE SHOWN EXISTING PLOT BOUNDARY LINE	---	
4) ALL DIMENSIONS ARE SHOWN PINK COLOUR		
5) EXISTING ROAD SHOWN LIKE THIS	---	
THIS DRAWING IS PREPARED AS PER THIS SUPPORTED & REF. DRAWING AS UNDER		
1) K.P.T. OLD DRG. NO. - LW / PL / 1067 DATE - 15-1-1971.		
2) D.L.R. DRG. NO. - M/RNO.1/2/13-14.		
3) GOOGLE EARTH & G.P.S. COORDINATES.		

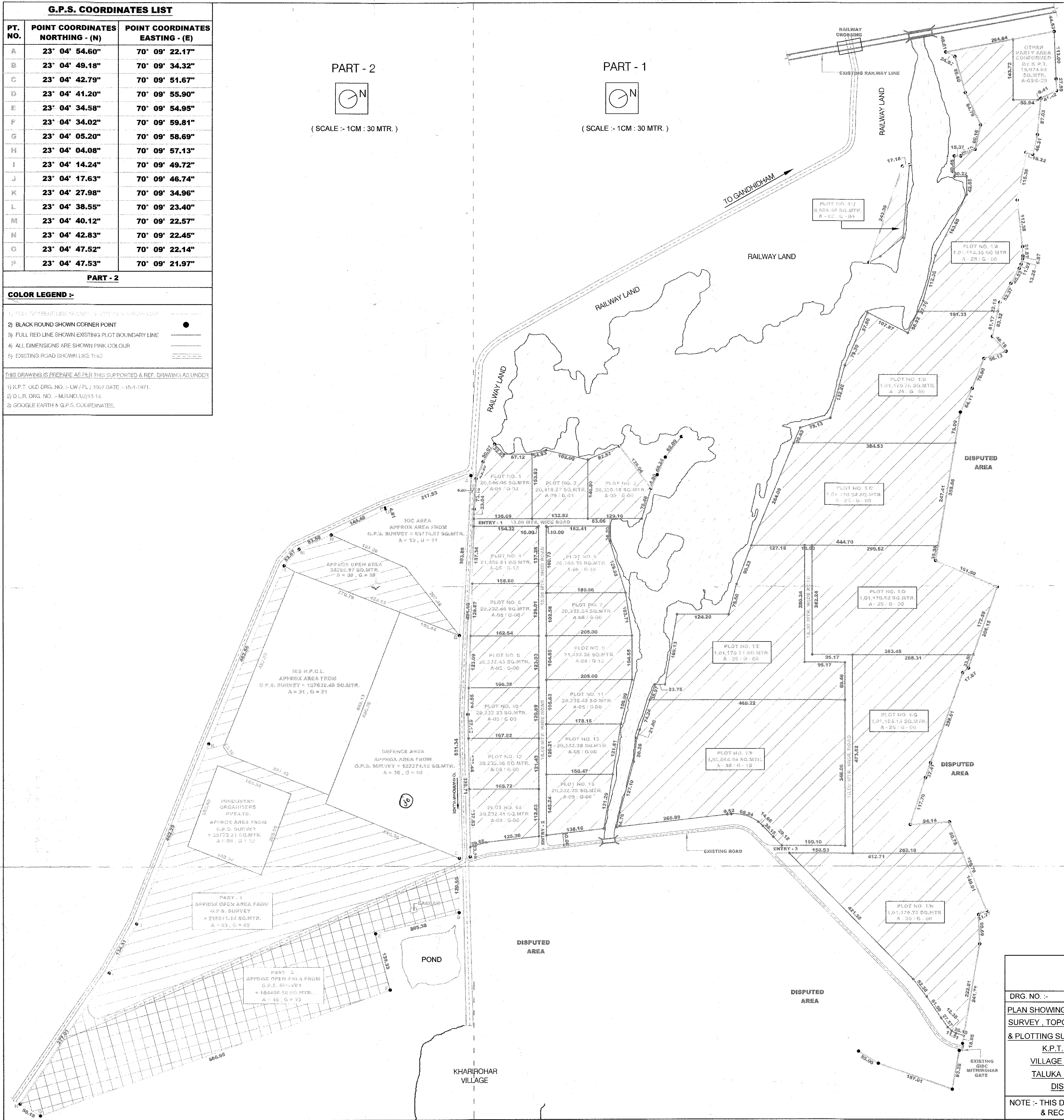

COLOR LEGEND :-	
1) FULL RED LINE SHOWN EXISTING PLOT BOUNDARY LINE	---
2) FULL RED LINE SHOWN PROPOSED PLOT BOUNDARY LINE	---
3) FULL BLUE LINE SHOWN RIVER EDGE LINE	---
4) BLACK ROUND SHOWN CORNER POINT	●
5) ALL DIMENSIONS ARE SHOWN PINK COLOUR	
6) EXISTING ROAD SHOWN LIKE THIS	---
7) EXISTING OVER BRIDGE SHOWN LIKE THIS	---
8) PROPOSED PLOT SHOWN LIKE THIS	---

AREA CALCULATION PART - 1 :-			
SR. NO.	TOTAL PLOT NO. & AREA (25 ACRE PLOTS)	AREA IN SQ.MTR.	AREA IN ACRE/GUNTHA
(1)	AREA OF PLOT NO. 1/A	1,01,174.39	A-25 / G-00
(2)	AREA OF PLOT NO. 1/B	1,01,170.76	A-25 / G-00
(3)	AREA OF PLOT NO. 1/C	1,01,170.34	A-25 / G-00
(4)	AREA OF PLOT NO. 1/D	1,01,170.52	A-25 / G-00
(5)	AREA OF PLOT NO. 1/E	1,01,170.71	A-25 / G-00
(6)	AREA OF PLOT NO. 1/F	1,55,654.04	A-38 / G-18
(7)	AREA OF PLOT NO. 1/G	1,01,193.13	A-25 / G-00
(8)	AREA OF PLOT NO. 1/H	1,01,175.73	A-25 / G-00
(9)	AREA OF PLOT NO. 1/J	8,585.98	A-02 / G-04
TOTAL AREA OF PART (A)		8,72,465.60	A-215 / G-24
SR. NO.	TOTAL PLOT NO. & AREA (05 ACRE PLOTS)	AREA IN SQ.MTR.	AREA IN ACRE/GUNTHA
(1)	AREA OF PLOT NO. 01	20,546.96	A-05 / G-03
(2)	AREA OF PLOT NO. 02	20,418.27	A-05 / G-01
(3)	AREA OF PLOT NO. 03	20,320.18	A-05 / G-00
(4)	AREA OF PLOT NO. 04	21,456.81	A-05 / G-12
(5)	AREA OF PLOT NO. 05	26,788.39	A-06 / G-24
(6)	AREA OF PLOT NO. 06	20,232.45	A-05 / G-00
(7)	AREA OF PLOT NO. 07	20,232.24	A-05 / G-00
(8)	AREA OF PLOT NO. 08	20,232.43	A-05 / G-00
(9)	AREA OF PLOT NO. 09	21,453.25	A-05 / G-12
(10)	AREA OF PLOT NO. 10	20,232.33	A-05 / G-00
(11)	AREA OF PLOT NO. 11	20,235.42	A-05 / G-00
(12)	AREA OF PLOT NO. 12	20,232.56	A-05 / G-00
(13)	AREA OF PLOT NO. 13	20,232.38	A-05 / G-00
(14)	AREA OF PLOT NO. 14	20,232.41	A-05 / G-00
(15)	AREA OF PLOT NO. 15	20,232.29	A-05 / G-00
TOTAL AREA OF PART (B)		3,13,078.37	A-77 / G-14
TOTAL LAND AREA IS		22,22,921.33 SQ.MTR. / A	549 / G - 12
TOTAL AREA OF PART (A)		8,72,465.60	A-215 / G-24
TOTAL AREA OF PART (B)		3,13,078.37	A-77 / G-14
TOTAL DISPUTED AREA		6,54,050.13	A-161 / G-25
TOTAL RIVER AREA		3,83,327.23	A-94 / G-26
TOTAL AREA		22,22,921.33	A-549 / G-12

CONTRACTOR COMPANY NAME	
M/S PREMJI KANJI SORATHIA	
NITINBHAI P.SORATHIA	

KANDLA PORT TRUST	
DRG. NO. :-	DATE :-
PLAN SHOWING EXISTING BOUNDARY SURVEY, TOPOGRAPHICAL SURVEY, & PLOTTING SURVEY WORK FOR THE	JR. ENG. (J.E.) S.D.O. (T.D.)
K.P.T. LAND NEAR VILLAGE :- KHARIROHAR TALUKA :- GANDHIDHAM DIST. :- KUTCH.	A.E.M. (LAND) XEN (T.D.) O.S.D. (ESTATE)
NOTE :- THIS DRAWING POINTS & AREA & POSITION TAKEN AS PER OLD DRG. & RECORD OF K.P.T. & SHOWN BY K.P.T. OFFICERS.	

Industrial Area		
Name of Area	Area in Sq. mt.	Area in Acres
1	24,812.262	6.13
2	30,452.570	7.52
3	30,399.231	7.51
4	15,115.597	3.74
5	15,065.690	3.72
6	24,229.700	5.99
7	10,849.143	2.68
8	11,006.940	2.72
9	11,009.613	2.72
10	20,515.750	5.07
11	21,899.200	5.41
12	10,855.952	2.68
13	10,880.283	2.69
14	11,098.960	2.74
15	20,277.511	5.01
16	12,034.165	2.97
17	10,832.281	2.68
18	10,761.708	2.66
19	21,468.157	5.30
20	21,468.157	5.30
21	19,129.113	4.73
22	9,391.047	2.32
23	10,894.710	2.69
24	10,716.193	2.65
25	10,751.097	2.66
26	11,109.412	2.75
27	10,718.946	2.65
28	9,594.460	2.37
29	32,957.447	8.14
30	30,781.117	7.61
31	48,449.892	11.97
32	48,373.212	11.95
33	33,421.718	8.26
34	74,226.539	18.34
35	45,976.531	11.36
36	46,978.535	11.61
37	48,319.573	11.94
38	31,568.549	7.80
39	35,298.462	8.72
40	34,972.526	8.64
41	38,761.058	9.58
42	25,555.278	6.31
43	35,065.365	8.66
44	39,580.304	9.78
45	37,434.279	9.25
46	10,045.029	2.48
47	76,802.907	18.98
48	82,527.738	20.39
49	2,15,026.319	53.13
50	2,04,339.794	50.49
51	97,500.342	24.09
52	96,397.978	23.82
<b>Total =</b>	<b>19,07,698.340</b>	<b>471.40</b>

Truck Terminal and Parking		
Name of Area	Area in Sq. mt.	Area in Acres
T1	15,830.261	3.91
T2	2,53,710.525	62.69
<b>Total =</b>	<b>2,69,540.786</b>	<b>66.60</b>

Residential Areas		
Name of Area	Area in Sq. mt.	Area in Acres
R1	47,236.056	11.67
R2	85,405.378	21.10
R3	29,858.952	7.38
R4	26,437.375	6.53
R5	5,961.020	1.47
<b>Total =</b>	<b>1,94,898.781</b>	<b>48.16</b>

Green Area / Open Space		
Name of Area	Area in Sq. mt.	Area in Acres
G1	6,960.336	1.72
G2	8,440.130	2.09
G3	7,882.840	1.95
G4	8,255.686	2.04
G5	14,109.721	3.49
G6	8,554.912	2.11
G7	12,495.333	3.09
G8	12,972.067	3.21
G9	12,037.500	2.97
G10	1,17,606.716	29.06
G11	7,640.424	1.89
G12	4,200.000	1.04
G13	2,829.836	0.70
G14	4,002.503	0.99
G15	12,231.037	3.02
G16	17,337.860	4.28
G17	10,388.378	2.57
G18	5,080.211	1.26
Green Strip S1	1,237.080	0.31
Green Strip S2	2,784.227	0.69
Green Strip S3	4,606.252	1.14
Green Strip S4	3,298.964	0.82
Green Strip S5	3,632.321	0.90
Green Strip S6	2,059.891	0.51
Green Strip S7	3,690.661	0.91
Retention Pond - 1	29,234.278	7.22
Retention Pond - 2	25,927.347	6.41
<b>Total =</b>	<b>3,49,496.511</b>	<b>86.36</b>

Utilities Area / Service Area			
Name of Area	Description	Area in Sq. mt.	Area in Acres
UL 1	33 KV Electric Sub Station & Flood P.S	9,829.356	2.43
UL 2	33 KV Electric Sub Station	3,977.623	0.98
UL 3	GSR/ESR/Pump House	16,449.016	4.06
UL 4	Sewage Treatment Plant	11,647.681	2.88
UL 5	220 KV GIS	12,109.922	2.99
UL 6	Flood P.S.	1,372.006	0.34
UL 7	Terminal SPS area	1,489.172	0.37
UL 8	33 KV Electric Sub Station	3,551.956	0.88
UL 9	Integrated Solid Waste Processing Area	17,675.644	4.36
UL 10	33 KV Electric Sub Station	5,328.186	1.29
UL 11	33 KV Electric Sub Station	10,256.555	2.53
UL 12	Storm Water Pumping Station	686.047	0.17
<b>Total =</b>		<b>94,265.164</b>	<b>23.29</b>

Amenity Ares / Retail / Community Center / Parking Station / Fire Station etc			
Name of Area	Description	Area in Sq. mt.	Area in Acres
A1	Retail, Dining Hall and ATM	7,248.490	1.79
A2	Retail, Dining, ATM, Petrol Pump etc.	17,727.729	4.38
A3 - 1	Fire Station	4500.000	1.11
A3 - 2	Police station	1,493.761	0.37
A4	Community Center, Retail, ATM, Medical Facility etc.	20,882.757	5.16
A5	Retail, Dining Hall and ATM	7,899.719	1.95
<b>Total =</b>		<b>59,753.456</b>	<b>14.76</b>

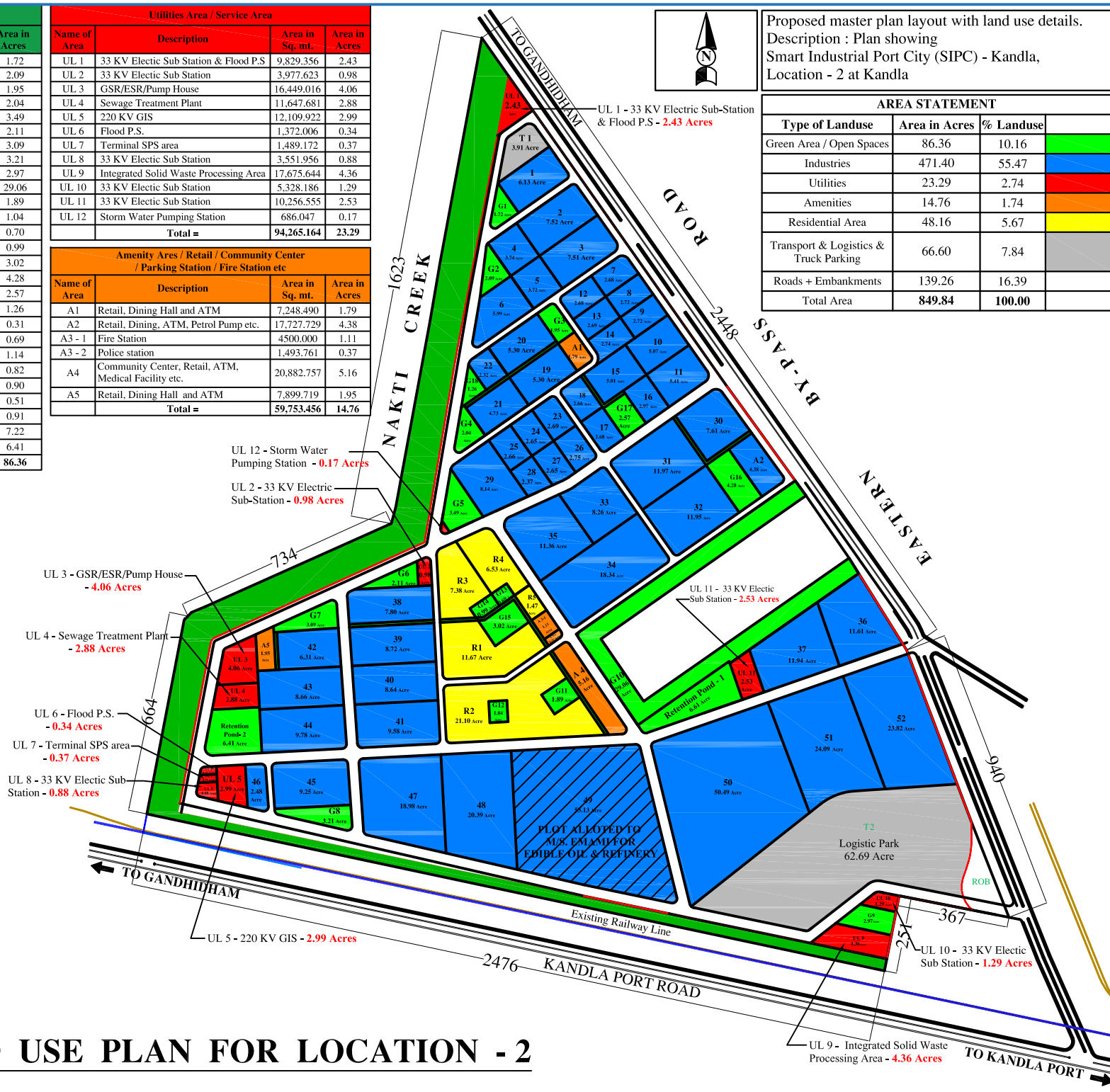

## LAND USE PLAN FOR LOCATION - 2